



14 Rose Street Chippendale NSW

4  1 

This classic wide-fronted terrace presents generous interiors, a versatile layout & a vibrant city fringe address. A home of distinct period character & flexibility.

View : <https://www.crystalrealty.com.au/lease/nsw/sydney-city/chippendale/residential/terrace/2618908>

Polished floors, high ceilings & striking archways feature throughout the lounge room & optional formal dining or 4th bedroom. The separate casual living/dining area flows through to a spacious gas kitchen plus a laundry with a downstairs w/c. Upstairs, the three bedrooms are all good sized, with the main bedroom featuring a traditional front terrace balcony.

At the rear of home is a private elevated deck, garden with leafy surrounds & pedestrian access to the rear lane. Enjoying a quiet leafy setting on one of Chippendale's premier street's, the property is close to Newtown eateries, Broadway Shopping Centre, Chippendale and Darlington

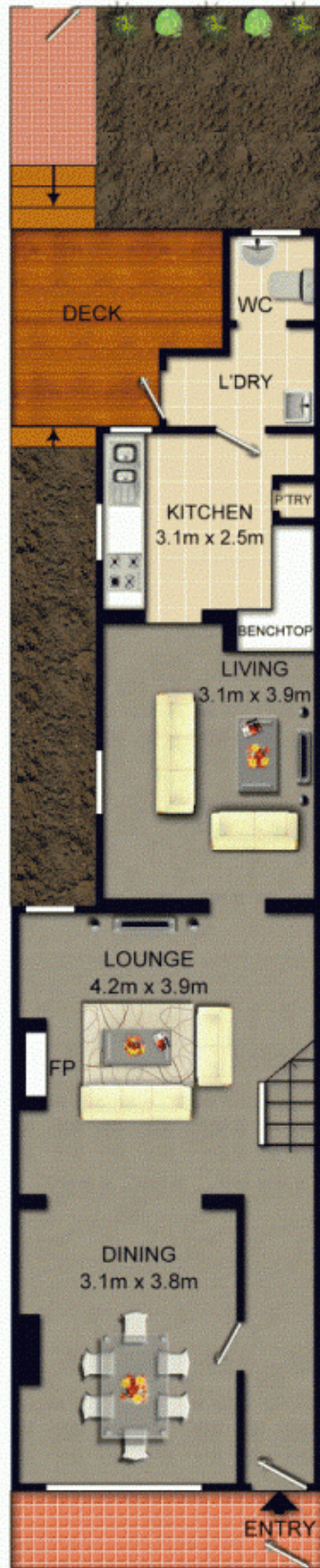

GROUND FLOOR

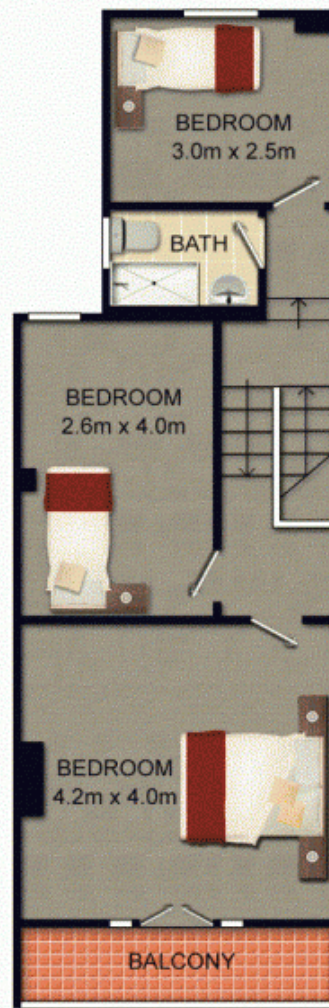

FIRST FLOOR



Scale shown in metres. All dimensions herein are approximate and gathered from sources believed to be reliable. Whilst every effort is made for the accuracy of our floor plans, interested parties should rely on their own enquires. Floor Plans by Industrie Media | industriemedia.tv



14 Rose Street, Chippendale

