



Level Ground/Shop2/104 Alice Street Newtown NSW

Situated within walking distance to bustling and vibrant King Street, Sydney Park and Marrickville Metro this ground floor space is suitable for a range of Use
 Current Use - Cafe
 Approximate size 33m2
 Airconditioned
 Separate storage room
 Toilet facilities for staff and customer use
 Current Equipment optional with terms
 - Walk-In/Walk-out or vacant possession available
 Outgoings - Water, Council and Strata.
 Lease terms negotiable
 Close to transport

Price : 39,950 pa
Building Size : 33 sqm
View : <https://www.crystalrealty.com.au/lease/nsw/inner-west/newtown/commercial/retail/8053897>



Christine Michaelopoulos
 0408 261 264

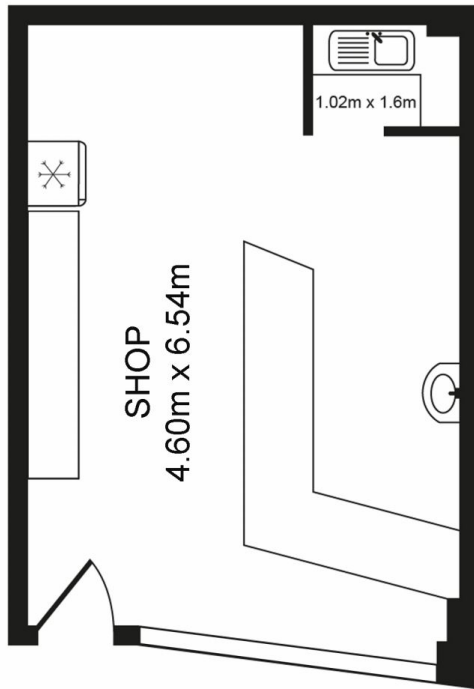

(NOT IN POSITION)

2/104 Alice St, Newtown NSW 2042

Whilst every attempt has been made to ensure the accuracy of the floor plan contained here, measurements of doors, windows, room and any other items are approximate and no responsibility is taken for any error, omission or mis-statement. This plan is for illustration purpose only and should be used as such by any prospective purchaser. The service, systems and appliances shown have not been tested and no guarantee as to their operability or efficiency can be given.

Photos & Floor Plan created by SMT Clicks | 0478 099 674

